

A8U40 CHASSIS

ROBUST 8U RAID

RUGGED ENTERPRISE CLASS

SYSTEMS ENGINEERED TO PERFORM™



The A8U40 Series Storage Server chassis represents the next generation providing high performance in a low cost 8U rack mount enclosure. Feature rich, the A8U40 Series is a solid, robust design which will meet the most rigorous and demanding

FEATURES

- Compact 8U x 26-inch design
- Front door provides drive security
- 1000-2500 Watt redundant power supply
- Forty Hot Swap 3.5-inch drive carriers
- Hold-down bar to secure installed feature cards
- Removable rack ears for bench top applications
- 5x120mm and 2x60mm internal fans for optimum cooling. Optional fans for extreme environments.
- Front panel status indicators
- Front panel USB connectors (behind drive door)
- Turnkey Configured Systems to Customer Spec



The Original Industrial Computer Source®

Chassis Plans · 8295 Aero Place · San Diego · CA · 92123
Phone (858) 571-4330 · Fax (858) 571-6146
saleseng@chassisplans.com
www.chassisplans.com
© 2007 Chassis Plans

A8U40CHASSIS

The enclosure is constructed of 18 gauge steel, clear zinc plated for corrosion protection and an attractive appearance. The front panel is attractively detailed and is of heavier gauge than the chassis.

There is huge drive storage with the provided forty front accessible 3-1/2 inch hot-swap drive sleds, floppy and slim CD.

A door covers and protects the drives. Accessible behind the door is the power and reset switches as well as the power-on and drive activity LED's. The LED's are visible through the door when it is closed. Two USB connectors are mounted behind the door.

Cooling is provided by five internal 120mm and two 60mm internally mounted fans. Other fan options are available. The cooling is optimized for high-power dual and quad-core processors for reliable operation.

The A8U40 Chassis provides for mounting an EATX (13x12") server class motherboard. An innovative card hold-down mechanism assures cards stay seated in high-G environments such as shipping.

Chassis Plans offers turn-key configured systems exactly built to customer specification and requirements.

Dimensions (W x H x D)

17 x 13.95 x 26.2-inch

Front Door

Front door covers drives

Front Panel Indicators

Power LED

Disk activity LEDs

Front Panel Controls/Connections

System reset switch

Power on/off switch

Two USB connectors

Drive Capacity

Forty 3.5-inch front drive bays

One floppy and one slim CD/DVD

Cooling Fans

Five 120mm and 2 60mm fans

Construction

18 gauge cold rolled steel

Clear zinc plated

Hold-down bar

Color

Black

Medium texture

Weight

53lbs. representative system

Environment

Operating and storage temperature, shock and humidity is dependant on installed components



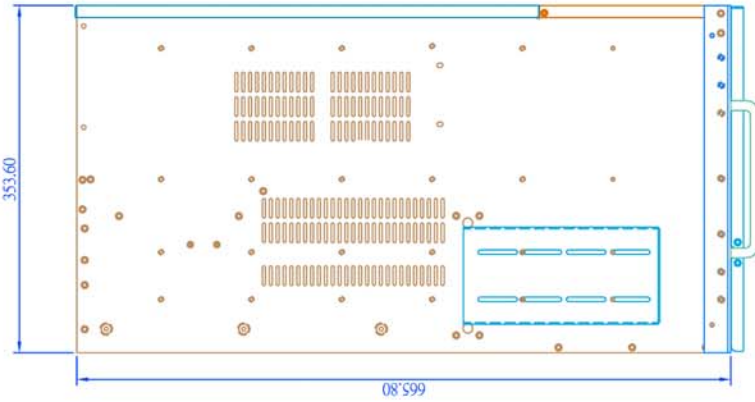

Front In-Side View
 1 x Slim CD-ROM + 1 x Slim FDD
 40 x 3.5" Hot Swap S-ATA HDD

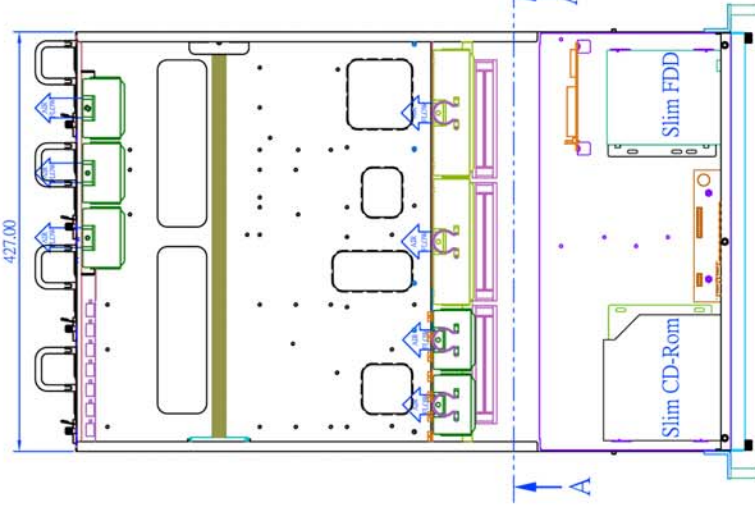

Front Out-Side View

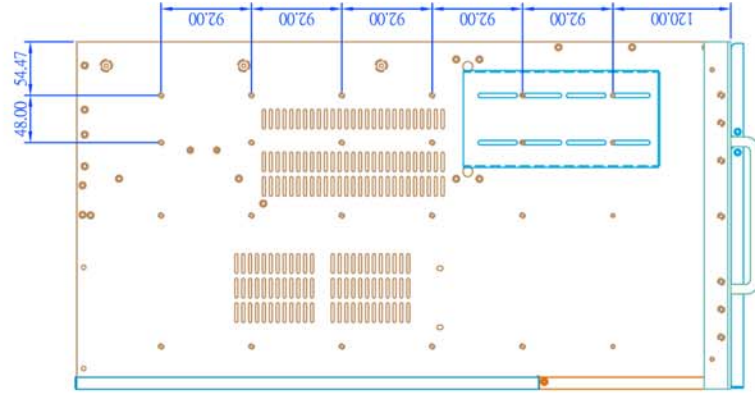

Section A - A
 2 x 60 mm Fans (23.5 CFM ea.)
 5 x 120mm Fans (90 CFM ea.)

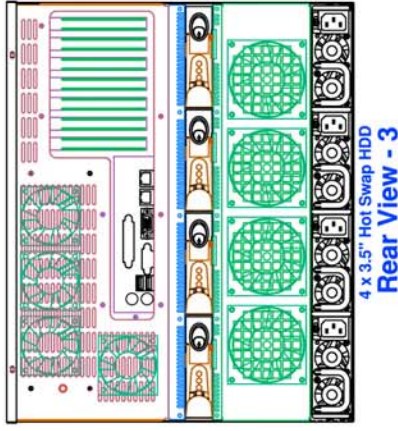

Rear View - 3
 4 x 3.5" Hot Swap HDD
 4 x 60 mm Fans (23.5 CFM ea.)

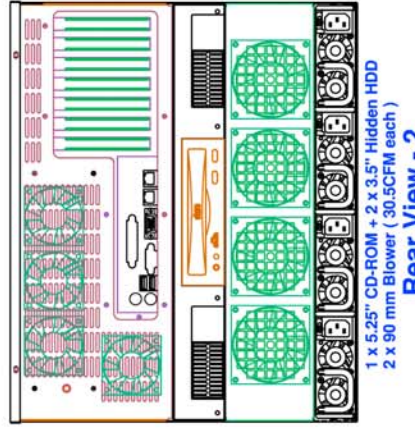

Rear View - 2
 1 x 5.25" CD-ROM + 2 x 3.5" Hidden HDD
 2 x 90 mm CD-Blower (30.5CFM each)
 4 x 80 mm Fans (42.5 CFM ea.)

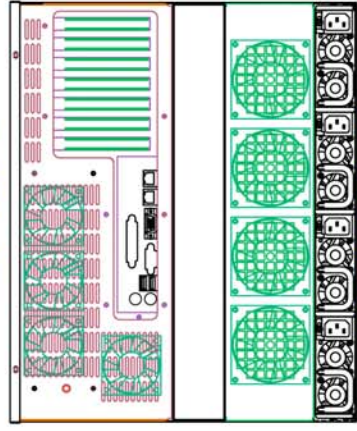

Rear View - 1 (Standard)
 4 x 60 mm Fans (23.5 CFM ea.)
 4 x 80 mm Fans (42.5 CFM ea.)

DIMENSIONS ARE IN MM		PROJECT	
PROJECTION	1:1	APPROVALS	DATE
TOLERANCES		DALIAN Swisher	04/21/07
DRAWING		DRAWN	
MATERIAL		CHECKED	
		DESIGNED	
		SCALE	1/1
		SHEET	14
		REV.	RO

Chassis Plans
A8U40
STORAGE SYSTEM
A8U40